

Mullumbimby Streetscape Upgrades

Concept Plan - Stuart Street Green Spine
Stage 1 Works

Prepared by Landsite & Hansen Partnership
JULY 2021
For Byron Shire Council



LANDSITE
landscape architecture



MULLUMBIMBY STREETSCAPE UPGRADES

CONCEPT PLAN -STUART STREET GREEN SPINE - STAGE 1

JULY 2021

DRAWING REGISTER

DRAWING NAME:	SHEET:	REVISION:
LSK- 001 CONTENTS & STUDY LOCATION	1/8	C
LSK- 002 STUDY AREA	2/8	B
LSK- 003 EXISTING CONDITIONS PLAN	3/8	C
LSK- 004 EXISTING CONDITIONS PLAN	4/8	C
LSK- 005 EXISTING TREE SCHEDULE	5/8	C
LSK- 006-S1 STUART STREET GREEN SPINE STAGE 1 PREFERRED CONCEPT PLAN	6/8	D
LSK- 007-S1 STUART STREET GREEN SPINE STAGE 1 PREFERRED CONCEPT PLAN	7/8	D
LSK- 008 STREET TYPOLOGY SECTIONS	8/8	B



LOCATION PLAN (COPYRIGHT NEARMAP) NOT TO SCALE



hansen

CLIENT
Byron Shire Council
70-90 Station Street, Mullumbimby 2462

PROJECT
Mullumbimby Streetscape Upgrades
Preferred Concept Plan -Stuart Street Green Spine

DRAWING TITLE
CONTENTS & STUDY LOCATION

DRAWN	CHECKED	SCALE
TC	SS	A1 A3 - -

PLOT DATE	JOB NUMBER	CLIENT REF
27/05/2021	20.0409	-
DRAWING NUMBER	REV	
LSK-001	D	

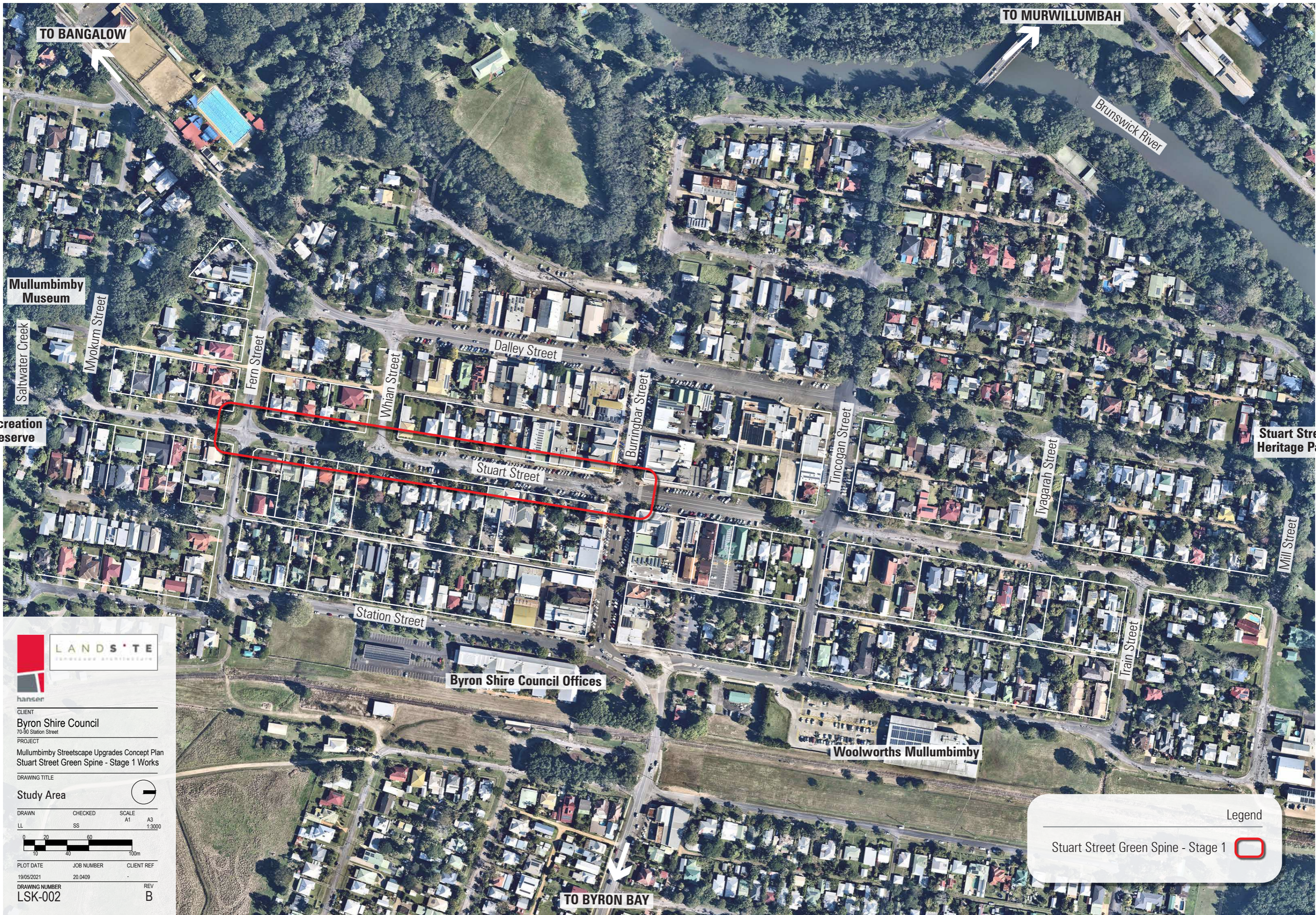

CLIENT
Byron Shire Council
70-90 Station Street

PROJECT
Mullumbimby Streetscape Upgrades Concept Plan
Stuart Street Green Spine - Stage 1 Works

DRAWING TITLE

Study Area

DRAWN
LL

CHECKED
SS

SCALE
A1
1:3000

A3

0 20 40 60 80 100m

PLOT DATE
19/05/2021

JOB NUMBER
20.0409

CLIENT REF

DRAWING NUMBER
LSK-002

REV
B

Legend

Stuart Street Green Spine - Stage 1 

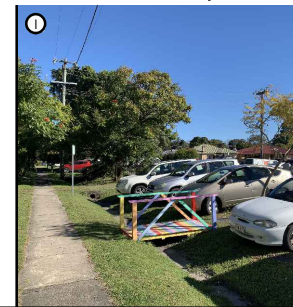
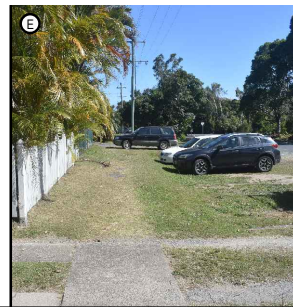
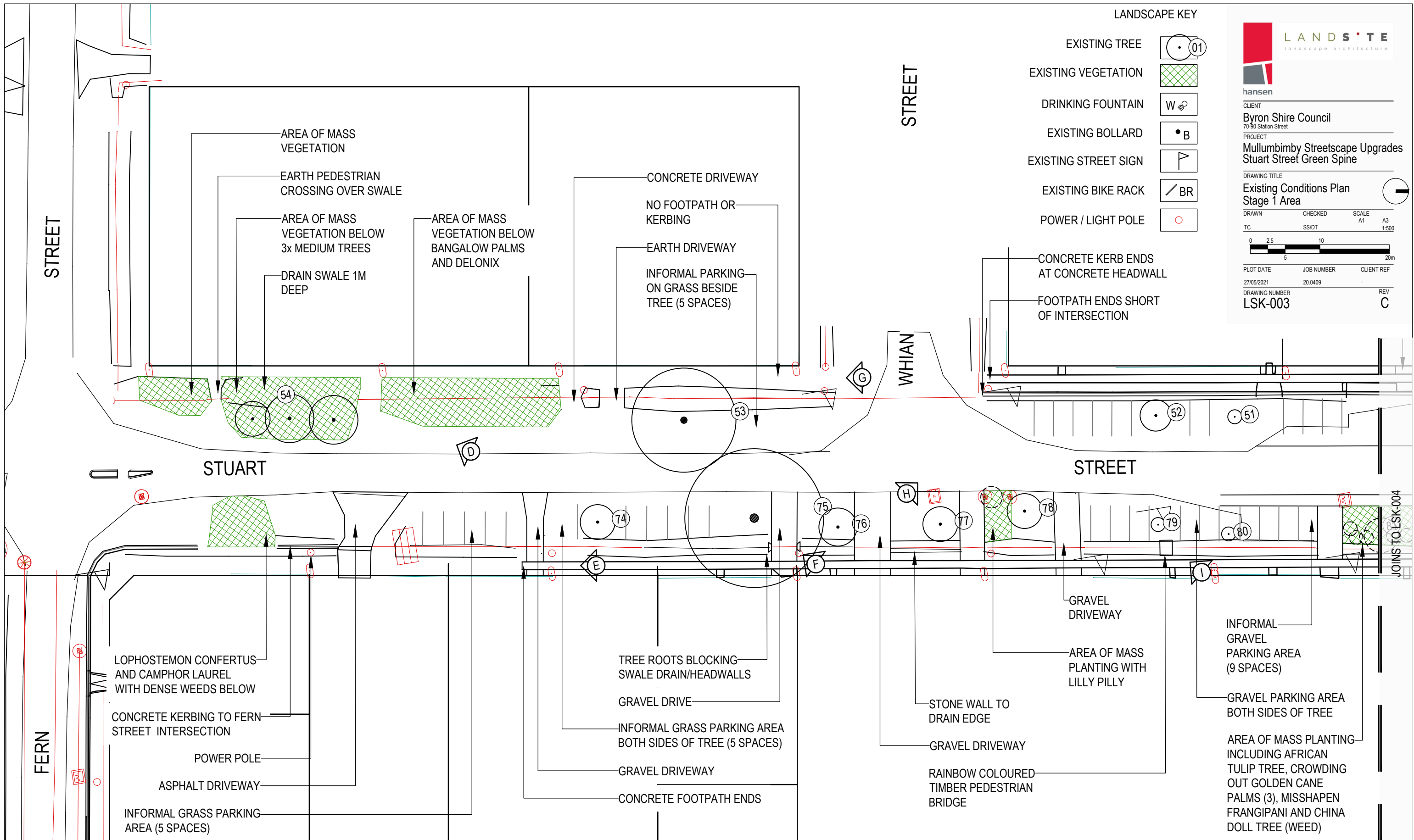

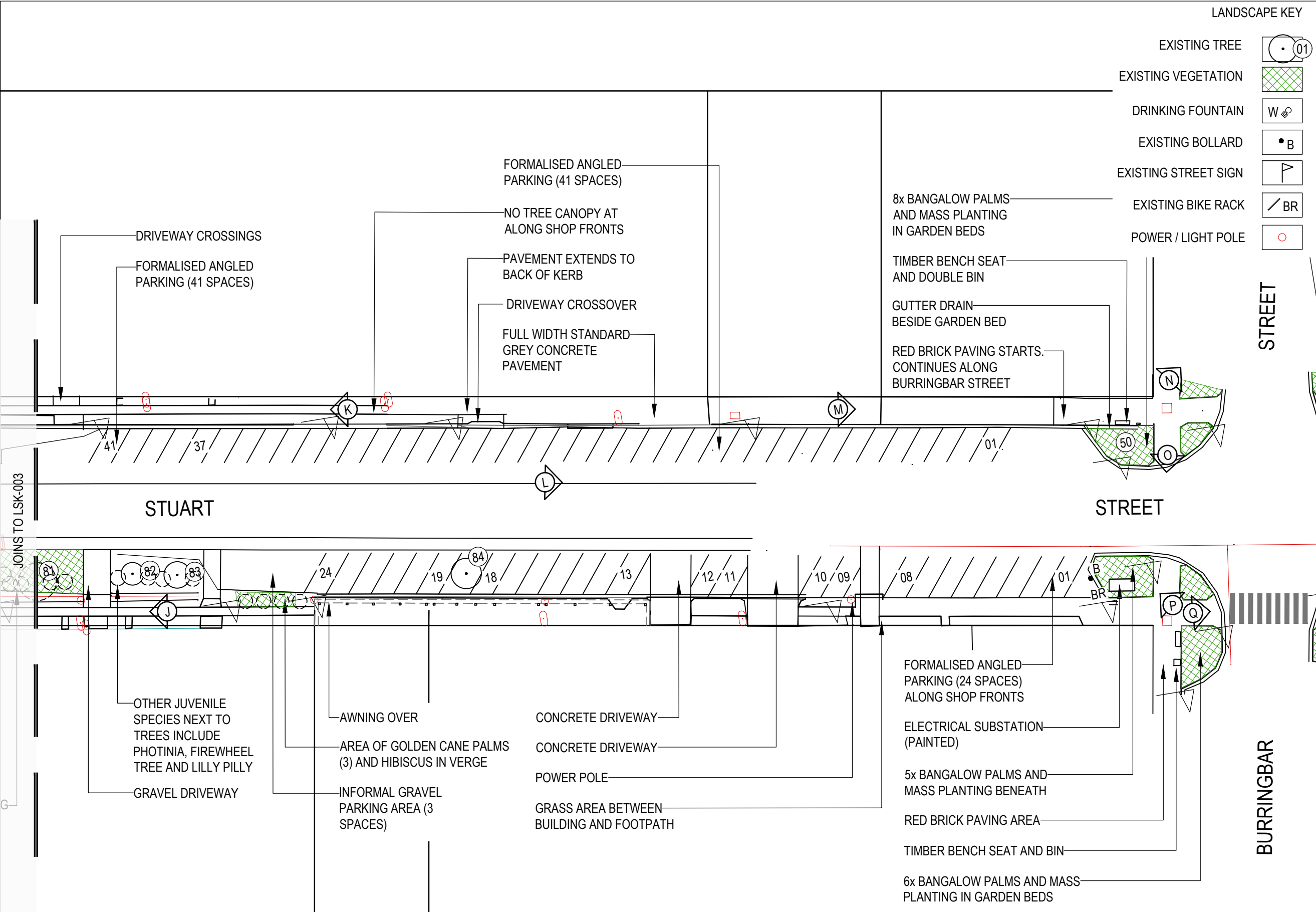

LANDSCAPE KEY

- EXISTING TREE
- EXISTING VEGETATION
- DRINKING FOUNTAIN
- EXISTING BOLLARD
- EXISTING STREET SIGN
- EXISTING BIKE RACK
- POWER / LIGHT POLE



CLIENT
Byron Shire Council
70-90 Station Street
PROJECT
Mullumbimby Streetscape Upgrades
Stuart Street Green Spine

DRAWING TITLE
Existing Conditions Plan
Stage 1 Area

DRAWN
TC
CHECKED
SS/DT
SCALE
A1
A3
1:500

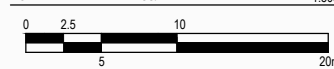

PLOT DATE
27/05/2021
JOB NUMBER
20.0409
CLIENT REF
-
DRAWING NUMBER
LSK-004
REV
C



STUART STREET EXISTING TREES - STAGE 1 AREA					
NUMBER	BOTANICAL NAME	COMMON NAME	HEIGHT	SPREAD	NOTES
50	8 x Archontophoenix cunninghamiana	Bangalow Palm	14.0m	4.0m	Area of existing mass planting under Bangalow Palms.
51	Spathodea campanulata	African Tulip Tree	4.0m	2.0m	
52	Spathodea campanulata	African Tulip Tree	6.0m	4.5m	
53	Lophostemon confertus	Brush Box	20.0m	15.0m	
54	3 x Unknown		10m	20.0m	Three medium trees with mass planting below.
55	2 x Syzygium jambos	Rose Apple	4.0m	4.0m	Unidentified.
56	Melaleuca sp.	Paperbark	6.0m	3.0m	
57	Waterhousea, Archontophoenix, Dyspis	Mix	15.0m	10.0m	Area of existing mass vegetation below trees.
58	Waterhousea floribunda	Weeping Lilly Pilly	6.0m	5.0-6.0m	
59	Melaleuca sp.	Paperbark	7.0-8.0m	6.0m	
60	Callistemon viminalis 'Dawson River Weeper'	Bottlebrush	5.0m	4.0m	
61	Dead tree	-	2.0m	0.5m	To be removed.
62	Archontophoenix cunninghamiana	Bangalow Palm	8.0m	3.0m	
63	Archontophoenix cunninghamiana	Bangalow Palm	8.0m	3.0m	
64	Callistemon viminalis 'Dawson River Weeper'	Bottlebrush	4.0m	4.0m	
65	Callistemon viminalis 'Dawson River Weeper'	Bottlebrush	4.0m	4.0m	
66	Araucaria heterophylla	Norfolk Island pine	9.0m	2.0-5.0m	
67	Lophostemon confertus	Brush Box	12.0m	5.0m	
68	Melaleuca sp.	Paperbark	11.0m	5.0m	
69	Callistemon viminalis 'Dawson River Weeper'	Bottlebrush	4.0m	5.0m	
70	Callistemon viminalis 'Dawson River Weeper'	Bottlebrush	7.0m	6.0m	
71	Callistemon viminalis 'Dawson River Weeper'	Bottlebrush	6.0m	5.0m	
72	Callistemon viminalis 'Dawson River Weeper'	Bottlebrush	5.0m	4.0m	
73	Lophostemon confertus	Brush Box	7.0m	6.0m	
74	Spathodea campanulata	African Tulip Tree	6.0m	5.0m	
75	Ficus obliqua	Small Leaved Fig	18.0-22.0m	18.0-20.0m	
76	Spathodea campanulata	African Tulip Tree	5.0m	5.5m	
77	Spathodea campanulata	African Tulip Tree	5.0m	5.0m	
78	Spathodea campanulata	African Tulip Tree	6.0m	5.0m	
79	Jacaranda mimosifolia	Jacaranda	2.5m	1.5m	
80	Waterhousea floribunda	Weeping Lilly Pilly	2.0m	1.5m	
81	Spathodea campanulata and 2 x Dyspis lutescens	Mix	6.0m	12.0m	Area of existing mass vegetation below trees.
82	Syzygium sp.	Lilly Pilly	4.0m	3.0m	Unidentified.
83	Spathodea campanulata	African Tulip Tree	4.5m	3.0m	
84	Spathodea campanulata	African Tulip Tree	6.0m	4.0m	Planted in carpark out stand.

NOTE: Only those trees within the current Stage 1 Concept Plan extents are listed in this table.



CLIENT
Byron Shire Council
70-90 Station Street

PROJECT
Mullumbimby Streetscape Upgrades
Stuart Street Green Spine

DRAWING TITLE
Existing Conditions Plan
Existing Tree Schedule

DRAWN	CHECKED	SCALE
TC	SS/DT	A1 A3



PLOT DATE	JOB NUMBER	CLIENT REF
27/05/2021	20.0409	-

DRAWING NUMBER	REV
LSK-005	C

STUART STREET PROPOSED TREE SPECIES

Residential Precinct Species



Flindersia schottiana - Bumpy Ash



Commercial Precinct Species



Harpullia pendula - Tulipwood

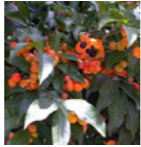

Threshold Treatment Species



Stenocarpus sinuatus - Firewheel Tree



LANDSCAPE KEY

EXISTING TREE



NEW TREE



TREE TO BE REMOVED



EXISTING FOOTPATH



NEW FOOTPATH



ON ROAD BIKE LANE



EXISTING GARDEN BED



PROPOSED GARDEN BED



GRASS AREA



ROAD SURFACE



EXISTING ROAD EDGE



PAINTED ROAD SURFACE



PROPOSED SPEED LIMIT



EXISTING TEMPORARY PARKLET



hansen

CLIENT

Byron Shire Council

70-90 Station Street

PROJECT

Mullumbimby Streetscape Upgrades

Stuart Street Green Spine

DRAWING TITLE

Preferred Concept Plan

Stage 1

DRAWN

TC

CHECKED

SS/DT

SCALE

A1

A3

1:500

PLOT DATE

23/07/2021

JOB NUMBER

20.0409

CLIENT REF

-

DRAWING NUMBER

LSK-006-S1

REV

D

0 2.5 10 20m

23/07/2021 20.0409 -

23/07/2021 20.0409 -

23/07/2021 20.0409 -

23/07/2021 20.0409 -

23/07/2021 20.0409 -

23/07/2021 20.0409 -

23/07/2021 20.0409 -

23/07/2021 20.0409 -

23/07/2021 20.0409 -

23/07/2021 20.0409 -

23/07/2021 20.0409 -

23/07/2021 20.0409 -

23/07/2021 20.0409 -

23/07/2021 20.0409 -

23/07/2021 20.0409 -

23/07/2021 20.0409 -

23/07/2021 20.0409 -

23/07/2021 20.0409 -

23/07/2021 20.0409 -

23/07/2021 20.0409 -

23/07/2021 20.0409 -

23/07/2021 20.0409 -

23/07/2021 20.0409 -

23/07/2021 20.0409 -

23/07/2021 20.0409 -

23/07/2021 20.0409 -

23/07/2021 20.0409 -

23/07/2021 20.0409 -

23/07/2021 20.0409 -

23/07/2021 20.0409 -

23/07/2021 20.0409 -

23/07/2021 20.0409 -

23/07/2021 20.0409 -

23/07/2021 20.0409 -

23/07/2021 20.0409 -

23/07/2021 20.0409 -

23/07/2021 20.0409 -

23/07/2021 20.0409 -

23/07/2021 20.0409 -

23/07/2021 20.0409 -

23/07/2021 20.0409 -

23/07/2021 20.0409 -

23/07/2021 20.0409 -

23/07/2021 20.0409 -

23/07/2021 20.0409 -

23/07/2021 20.0409 -

23/07/2021 20.0409 -

23/07/2021 20.0409 -

23/07/2021 20.0409 -

23/07/2021 20.0409 -

23/07/2021 20.0409 -

23/07/2021 20.0409 -

23/07/2021 20.0409 -

23/07/2021 20.0409 -

New footpath to connect with existing path

Existing Brush Box tree to be retained

Existing Fig tree to be retained

Existing African Tulip Trees to be removed

Bike lane each side of Stuart Street

New footpath to connect with existing path

Existing African Tulip Tree to be removed

Informal parking areas on grass nature strip

Existing African Tulip Trees and Lilly Pilly to be removed

Existing Jacaranda tree to be retained

Existing Weeping Lilly Pilly tree to be removed

Mass planting and feature trees to mark threshold between residential and commercial precincts

Existing planting area to be removed and replaced by angled parking. Planting area comprises African Tulip Tree, crowding out Golden Cane Palms (3), misshapen Frangipani and China Doll Tree (weed)

Parking Spaces - Residential Precinct (between Fern Street and Threshold Treatment)

Existing parking spaces: 52
Proposed parking spaces: 52



- LANDSCAPE KEY
- EXISTING TREE
 - NEW TREE
 - TREE TO BE REMOVED
 - EXISTING FOOTPATH
 - NEW FOOTPATH
 - ON ROAD BIKE LANE
 - EXISTING GARDEN BED
 - PROPOSED GARDEN BED
 - GRASS AREA
 - ROAD SURFACE
 - EXISTING ROAD EDGE
 - PAINTED ROAD SURFACE
 - PROPOSED SPEED LIMIT
 - EXISTING TEMPORARY PARKLET

CLIENT
Byron Shire Council
70-90 Station Street

PROJECT
Mullumbimby Streetscape Upgrades
Stuart Street Green Spine

DRAWING TITLE
Preferred Concept Plan
Stage 1

DRAWN	CHECKED	SCALE	A1	A3
TC	SS/DT			1:500

PLOT DATE	JOB NUMBER	CLIENT REF
23/07/2021	20.0409	-

DRAWING NUMBER	REV
LSK-007-S1	D

Activation area (dashed line). Parklet to remain until December 2021. Council to determine final use of area following outcome of trial.

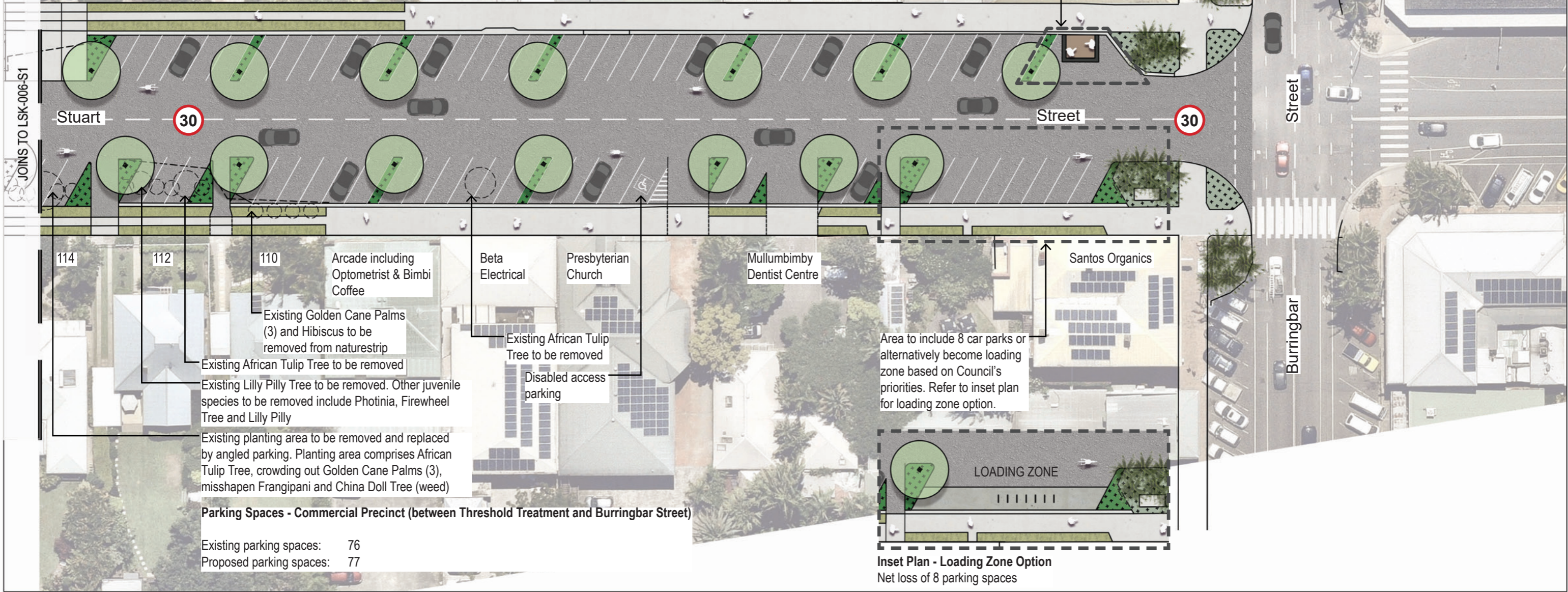

Existing Golden Cane Palms (3) and Hibiscus to be removed from naturestrip

Existing African Tulip Tree to be removed

Existing Lilly Pilly Tree to be removed. Other juvenile species to be removed include Photinia, Firewheel Tree and Lilly Pilly

Existing planting area to be removed and replaced by angled parking. Planting area comprises African Tulip Tree, crowding out Golden Cane Palms (3), misshapen Frangipani and China Doll Tree (weed)

Beta Electrical

Presbyterian Church

Mullumbimby Dentist Centre

Existing African Tulip Tree to be removed

Disabled access parking

Area to include 8 car parks or alternatively become loading zone based on Council's priorities. Refer to inset plan for loading zone option.

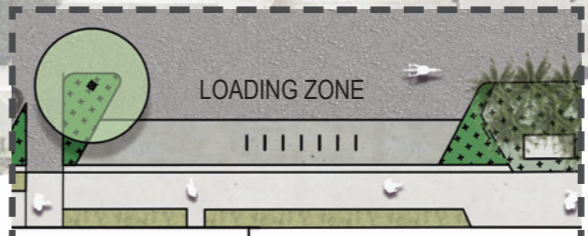

Parking Spaces - Commercial Precinct (between Threshold Treatment and Burringbar Street)

Existing parking spaces:	76
Proposed parking spaces:	77

Inset Plan - Loading Zone Option
Net loss of 8 parking spaces

**COMMERCIAL PRECINCT
TYPICAL SECTION**

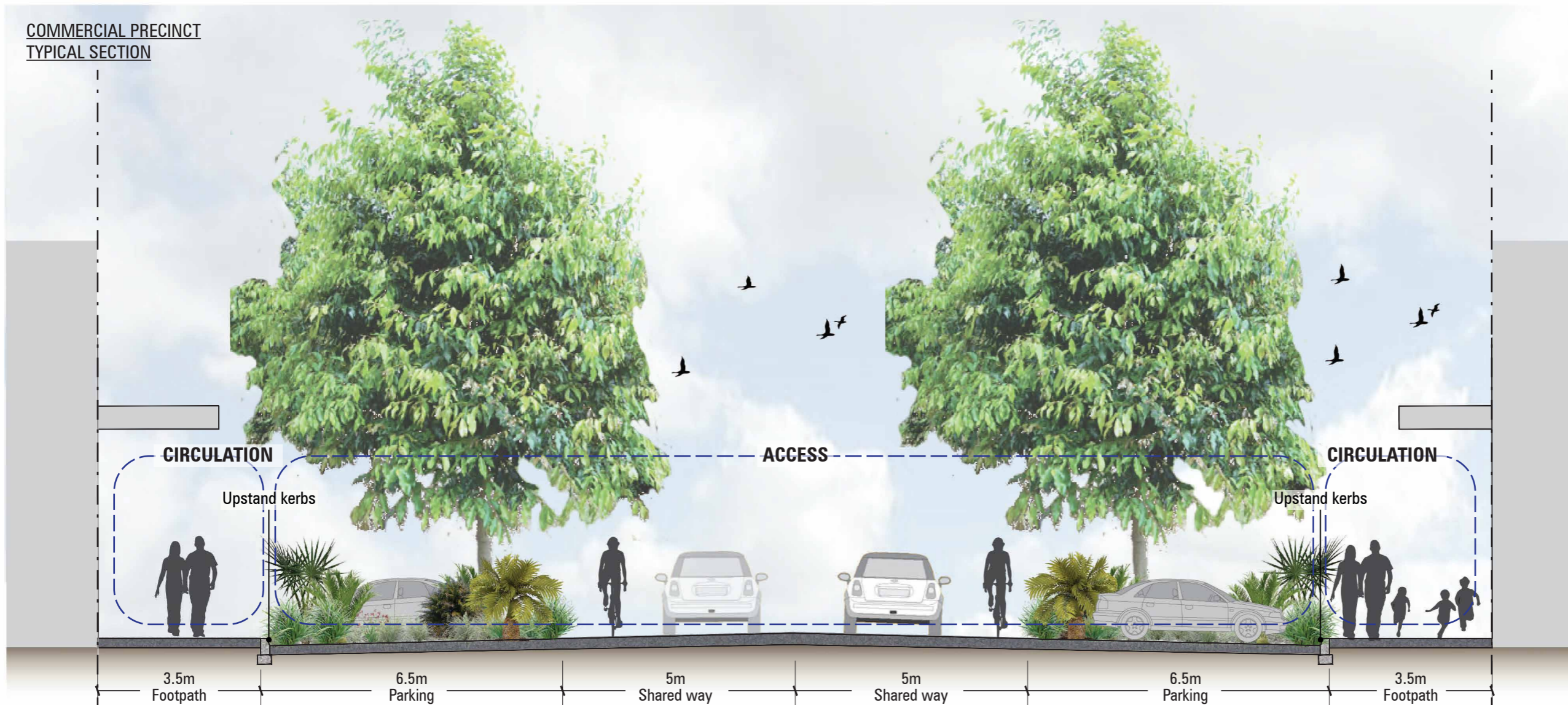

**RESIDENTIAL PRECINCT
TYPICAL SECTION**

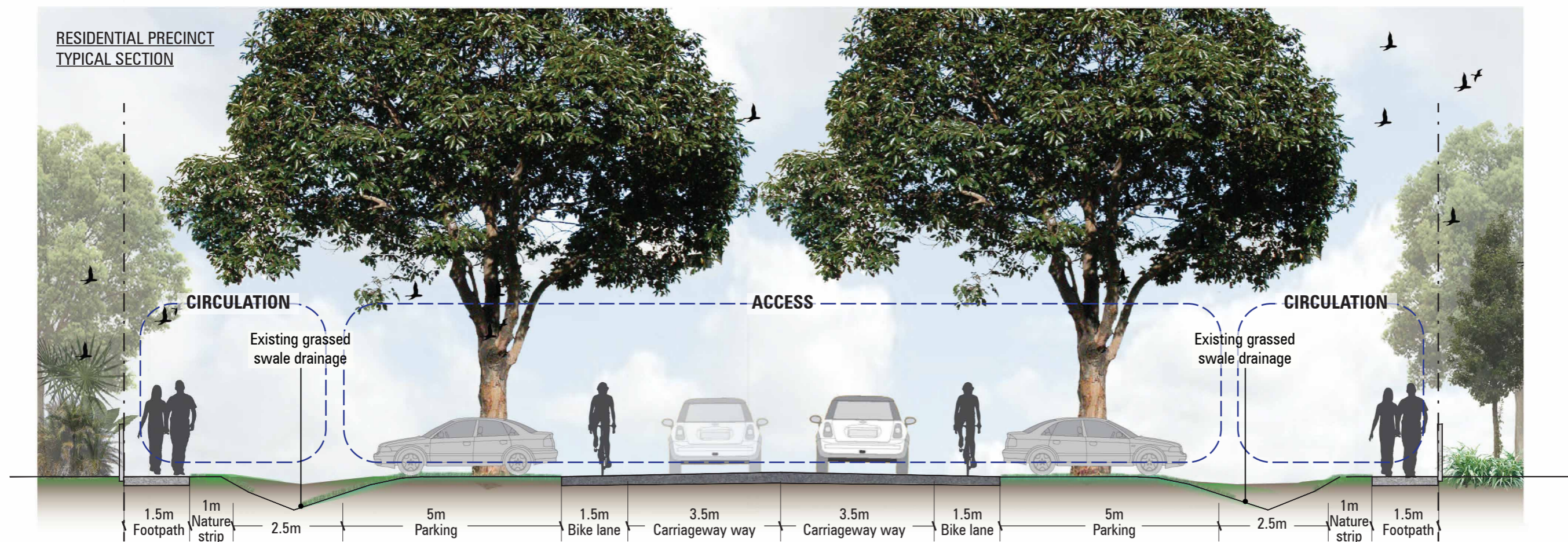

hansen

CLIENT

Byron Shire Council
70-90 Station Street

PROJECT

Mullumbimby Streetscape Upgrades Concept Plan
Stuart Street Green Spine - Stage 1 Works

DRAWING TITLE

Street Typology Sections

DRAWN	CHECKED	SCALE	A3
LL	SS	A1	1:200

0 0.5 2 4m

PLOT DATE	JOB NUMBER	CLIENT REF
19/05/2021	20.0409	-

DRAWING NUMBER

LSK-008

REV

B